

A List of
SPARE & REPLACEMENT PARTS
for the
1959

Royal Enfield
"Made like a Gun"

MOTOR CYCLE

"PRINCE"

148 c.c. Spring Frame Two-Stroke



THE
ENFIELD CYCLE COMPANY LIMITED

Head Office & Works:

REDDITCH, WORCESTERSHIRE

ENGLAND



October, 1959.

BRITCYCLE
www.britcycle.com.au

Price 2/-

A List of
SPARE & REPLACEMENT PARTS
for the
1959

Royal Enfield

MOTOR CYCLE

“PRINCE”

148 c.c. Spring Frame Two-Stroke



THE
ENFIELD CYCLE COMPANY LIMITED

Head Office & Works:

REDDITCH, WORCESTERSHIRE

ENGLAND

Telegrams:
“Cycles, Phone, Redditch.”

Telephone:
Redditch 121 (9 lines)



INDEX

	Page
Battery Box	28
Brakes	16,18
Brake Pedal and Rod	22
Carburettor and Air Filter	30
Chaincase (primary)	6
Chainguard (rear)	22
Clutch Assembly	6
Control Cables	24
Crankcase	4,6
,, Studs etc.	4,6
Crankshaft	4
Cylinder	4
Dual Seat	28
Engine Complete	4
Exhaust System	26
Flywheel and Footstarter Cover	6
Footgear Change	10
Footstarter Mechanism	8
Footrests	12
Fork Assembly	14
Frame and Rear Suspension	12
Gearbox	8
Generator, Electrical	32
Guarantee	36
Handlebar and Controls	24
Lamps, Head and Tail	34
Legshields	30
Mudguards and Carrier	20
Number Plates	20
Petrol Tank	22
Pillion Footrests	26
Piston	4
Primary Drive	6
Rectifier and Horn	34
Speedometer and Drive	16
Stand	26
Toolbox and Tools	28
Wheel (front)	16
,, (rear)	18

State colour when ordering enamelled parts.

See notes on page 18.

TERMS OF BUSINESS

All prices of Spare and Replacement Parts are subject to revision or modification, at our discretion, without notice.

Our terms are **STRICTLY NET CASH WITH ORDER**, or cash on receipt of **PRO-FORMA INVOICE**. Repairs and sundries items cannot be booked. Prices do not include cost of carriage or postage which will be covered by a percentage increase on the nett invoice value. C.O.D. fees and the cost of packing cases or crates are additional to the fixed surcharge.

Any part or complete motor cycle sent for repair should be consigned **CARRIAGE PAID** and the sender's name and address should be given in full on the address tally. Parts sent to us carriage forward are liable to be refused, and to lie with the carriers at senders' risk and expense.

Full instructions regarding the necessary repairs to be done, with advice as to the mode of despatch of the machine (or part), should be posted the same day.

When forwarding motor cycles for repair it is advisable to remove all accessories and easily detached fittings, such as badges, mascots, tools, tyre inflator, etc. Besides facilitating the work of repair, it will also prevent any loss during transit.

Order all parts by the name of the article and the **NUMBER PRECEDING IT**, also state the number of the engine or machine for which they are intended. The engine number will be found stamped on the top of the crankcase above the flywheel magneto housing and the machine number at the top of the front down tube.

GUARANTEE

We respectfully refer customers to the terms of guarantee which appears on page 36 of this list.

When forwarding a complete Motor Cycle, Engine or other Assembly with the request that we overhaul the same, we understand by the term "Overhaul" that it is to be entirely dismantled, thoroughly renovated, any worn parts renewed, and put in perfect working order. In case a customer desires only certain parts attended to, full instructions should be given to that effect, otherwise the cost may be in excess of that anticipated.

ESTIMATES AND QUOTATIONS

When customers send complete Motor Cycles or parts thereof to us for repairs, we are always prepared to furnish estimates before proceeding with the necessary work. At the same time, it must be distinctly understood that we can give only approximate quotations. Frequently, when the actual work is in progress, it is found necessary to replace parts other than those specified in the estimate, as we make a practice of including in such estimates only those items and parts which at the time we consider really essential to put the machine (or parts) in a thoroughly satisfactory condition. We recommend the use of our Service Replacement Unit.

If any estimate prepared in this way is not accepted, we reserve the right to make a charge for taking down and re-assembling any parts necessary in preparing it.

We cannot hold ourselves responsible for loss of, or damage to, any parts lying at our Works for repairs, unless instructions to proceed with same are given within twenty-one days of our estimate for the said repairs having been rendered.

All welded repairs to crankcases and other aluminium parts are carried out with extreme care, but we cannot give any guarantee with, or accept responsibility for, any parts so treated.

ENGINE, CRANKCASE, CHAINCASE & FOOTSTARTER COVER .

Illus. No.	No. of part.	Description.	No. per set.
	44679.. ..	Engine/gear unit c/w generator and carburettor	1
	44680.. ..	Engine/gear unit c/w generator less carburettor	1
1	ST/30.. ..	Engine gasket set	1
2	43093.. ..	Cylinder head	1
3	43094.. ..	" barrel	1
4	38422.. ..	" base washer	1
5	38427.. ..	Carburettor flange washer	1
6	34744.. ..	" " screw	2
7	27916.. ..	" " " washer	2
	40800.. ..	Piston c/w rings, gudgeon pin and circlips (std)	1
	40800/15 ..	" complete (.015" oversize)	1
	40800/30 ..	" " (.030" ")	1
8	38414.. ..	Piston ring (std.)	2
	38414/15 ..	" " (.015" oversize)	2
	38414/30 ..	" " (.030" ")	2
9	26437.. ..	Gudgeon pin	1
	26437/5 ..	" " (.005" oversize)	1
	26437/10 ..	" " (.010" ")	1
10	26710.. ..	" " circlip	2
	44675.. ..	Crankshaft assy.	1
11	44676.. ..	" drive side	1
12	44678.. ..	" flywheel side	1
13	28457.. ..	Connecting rod with small end bush..	1
14	19278.. ..	Small end bush	1
15	30553.. ..	Crankpin	1
16	27423.. ..	" roller	12
17	27292.. ..	" thrust washer	2
18	44681.. ..	*Crankcase c/w studs, bushes, bearings, and fixed fittings	1
19	26709.. ..	" dowel	2
20	SK/6204 ..	Ball bearing, 20 x 47 x 14 m.m.	4
21	34604.. ..	" " distance collar	1
22	37339.. ..	" " circlip Seeger 1 1/2" int.	1
23	36049.. ..	Compression seal washer (D/S housing)	1
24	35765.. ..	" " " (T/S ")	1
25	39304.. ..	" " seal (F/wheel side)	1
26	38428.. ..	Cylinder head stud 1/2" x 5 1/2" x 22 BSF	4
27	34705.. ..	" " " nut	4
28	8634.. ..	" " " washer	4
29	35793.. ..	Crankcase stud 1/2" x 2" x 26 BSF	1
30	35797.. ..	" " front 1/2" x 2 1/2" x 26 BSF	1
31	35798.. ..	" " top 1/2" x 3 1/2" x 26 BSF	1
32	35799.. ..	" " btm. 1/2" x 3 1/2" x 26 BSF	1
33	37341.. ..	Gearbox "Allen" type set screw 1/2" x 1" x 26 BSF.	1
34	37340.. ..	" " " 1/2" x 1 1/2" x 26 BSF.	2
35	35796.. ..	Gearbox stud 1/2" x 4 1/8" x 26 BSF.	1
	27620.. ..	Footstarter cover stud nut (behind gearbox)	1
36	27622.. ..	Crankcase stud nut	7
37	5915.. ..	" " washer	8
38	35763.. ..	Gearbox filler plug	1
39	9782.. ..	" " " washer	1
40	35779.. ..	" (gear lever stud) plug	1

* NOTE.—The crankcase assy. does not include the primary chain case or foot starter cover.

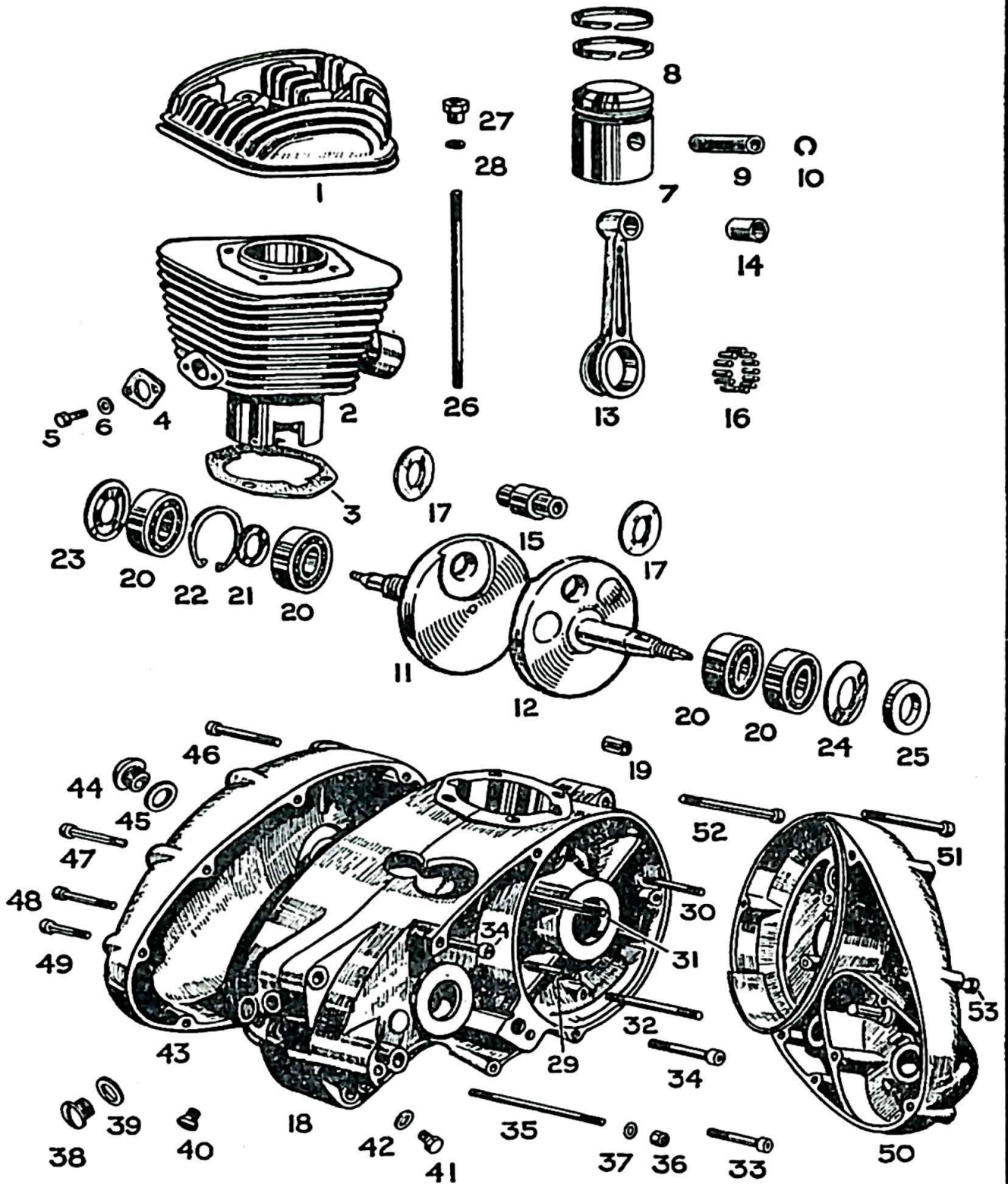

S 159

ENGINE, CRANKCASE, CHAINCASE & FOOTSTARTER COVER—Contd.

Illus. No.	No. of part.	Description.	No. per set.
41	41700.. ..	Gearbox drain plug	1
42	80895.. ..	" " " washer	1
43	85862.. ..	Chaincase and clutch worm bush	1
44	85762.. ..	" filler plug	1
45	85863.. ..	" " " washer	1
46	85866.. ..	" ch.hd. screw $\frac{1}{4}" \times 2" \times 26$ BSF.	4
47	84898.. ..	" " " $\frac{1}{4}" \times 1\frac{1}{8}" \times 26$ BSF.	2
48	85867.. ..	" " " $\frac{1}{4}" \times 1\frac{1}{2}" \times 26$ BSF.	1
49	85868.. ..	" " " $\frac{1}{4}" \times 1\frac{1}{8}" \times 26$ BSF.	2
FLYWHEEL & FOOTSTARTER COVER			
50	84762.. ..	Cover with fixed fittings	1
51	84898.. ..	" ch. hd. screw $\frac{1}{4}" \times 1\frac{1}{8}" \times 26$ BSF.	2
52	87252.. ..	" " (Spl.) $\frac{1}{4}" \times 1\frac{1}{8}" \times 26$ BSF.	2
53	84741.. ..	" " screw $\frac{1}{4}" \times 1\frac{1}{8}" \times 26$ BSF.	1

CLUTCH & PRIMARY DRIVE

1	40694A ..	Clutch drum	1
2	42665.. ..	Friction plate assy. with 14T sprocket	1
4	87185.. ..	Floating bush	1
5	42878.. ..	Driving plate	1
6	10814.. ..	" " securing nut	1
7	5025.. ..	" " washer	1
9	48701.. ..	Pressure plate	1
10	40696.. ..	" " spring	6
11	85862.. ..	" " " cap	6
12	86975.. ..	" " and drum circlip	1
13	85756.. ..	Clutch worm bush	1
14	86686.. ..	" " and drum assy.	1
15	87247.. ..	" " " " return spring	1
16	84602.. ..	Pressure plate disc	1
17	82018.. ..	" " " ball	1
18	87197.. ..	" " thrust pin	1
19	40685.. ..	Drive shaft nut	1
20	40686.. ..	" " compression seal	1
21	RN/110088/46	Primary chain, .375" pitch \times .225" wide and 46 pitches	1
	45129.. ..	Primary driven sprocket and cush drive assy.	1
22	45126.. ..	Sprocket only, 29T	1
23	45125/1 ..	Drive plate with cush drive bushes	1
24	45127.. ..	Cush drive bush	5
25	45128.. ..	" " " pin	5
26	45007.. ..	Circlip	1
27	17504A ..	Drive plate key	1
28	5205.. ..	" " washer	1
29	44912.. ..	" " nut	1

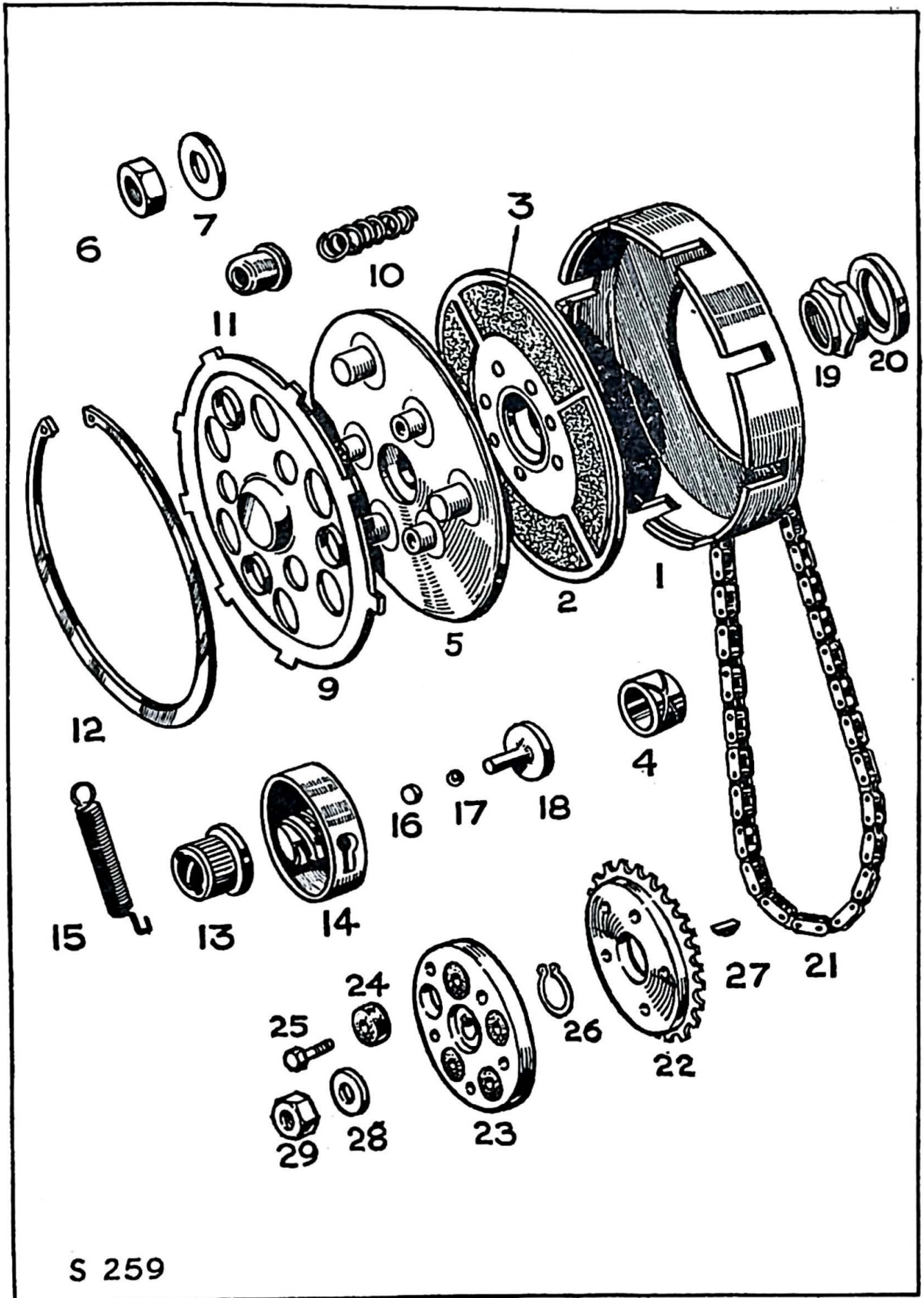

S 259

GEARBOX—SHAFTS, GEARS, BEARINGS

Illus. No.	No. of part.	Description.	No. per set.
1	44897.. ..	Mainshaft	1
2	SK/6204 ..	" high gear bearing, 20×47×14 m.m.	1
3	29858.. ..	" " " felt washer ..	1
4	29881.. ..	" " " " retainer ..	1
5	29882.. ..	" " " oil retainer ..	1
6	44534.. ..	" high gear 22T. ..	1
7	44537.. ..	" sliding gear 18T. ..	1
8	44538.. ..	" small gear 15T. ..	1
9	SK/6802 ..	" ball bearing, 15×42×13 m.m.	1
10	44829.. ..	" " " oil seal ..	1
12	34439.. ..	Layshaft	1
13	26496.. ..	" bush—flywheel side ..	1
14	34442.. ..	" " —clutch side ..	1
15	44532.. ..	" small gear 13T. ..	1
16	44536.. ..	" sliding gear 18T. ..	1
17	44701.. ..	" large gear 26T and bush ..	1
18	35950.. ..	" " " bush only ..	1
19	34438.. ..	Secondary drive sprocket, 14T. ..	1
20	29867.. ..	" " " locknut ..	1
21	35515.. ..	" " " " screw ..	1
22	34612.. ..	Footstarter ratchet (on mainshaft) ..	1
23	34611.. ..	" pinion	1
24	40390.. ..	" ratchet spring	1
25	37825.. ..	" pinion spindle	1
25A	37824.. ..	" " " nut	1
26	44688.. ..	" crank	1
27	34371.. ..	" " clamp bolt	1
28	11509.. ..	" " " " nut	1
29	27917.. ..	" " " " washer ..	1
30	35408.. ..	" quadrant and spindle ..	1
31	36974.. ..	" " locating peg	1
32	34614.. ..	" " bush	1
33	34616.. ..	" return spring	1
34	37153.. ..	" " " peg	1
35	35772.. ..	" quadrant cover plate and peg ..	1
36	37576.. ..	" " stop peg	1
37	35864.. ..	" " cover plate screw ..	2

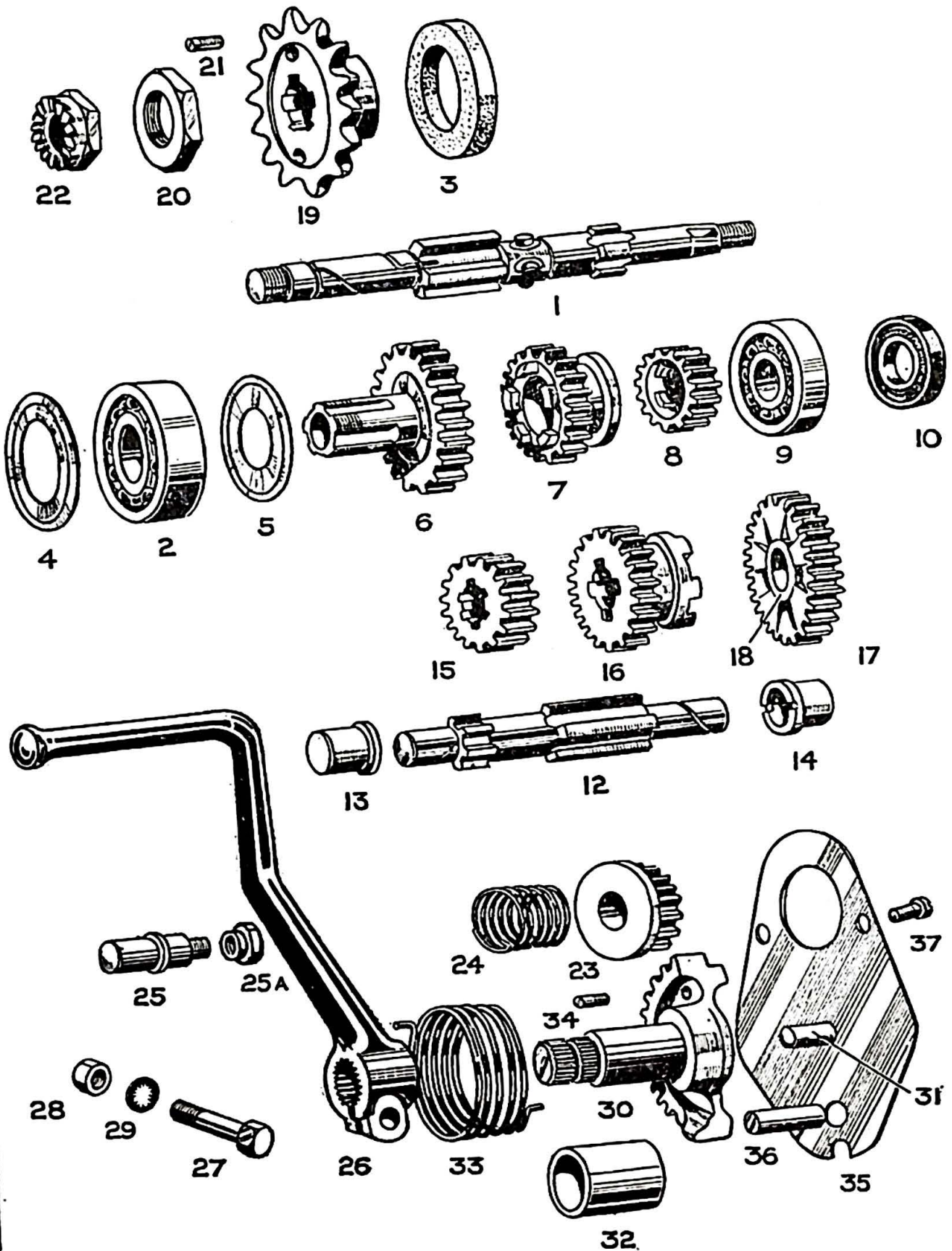

S 359

FOOT GEAR CHANGE

Illus. No.	No. of part.	Description.	No. per set.
1	34766.. ..	F/C lever	1
2	34767.. ..	" " screw	1
3	34577.. ..	" spindle	1
4	35778.. ..	" " bush (in F/S cover)	2
5	34578.. ..	" " " (in crankcase)	1
6	TC/PZ6 ..	" " grease nipple	1
7	36839.. ..	" " return spring	1
8	35405.. ..	" " " " peg	1
10	36048.. ..	" pawl carrier	1
11	3693.. ..	" " " key	1
12	DE627 ..	" " " " nut	1
13	32393.. ..	" " " " washer	1
14	36040.. ..	" pawl (bottom)	1
15	36041.. ..	" " (top)	1
16	34568.. ..	" " plunger	2
17	34569.. ..	" " " spring	1
18	34571.. ..	" ratchet	1
19	34561.. ..	" " lever	1
20	27622.. ..	" " " nut	1
	27916.. ..	" " " " washer	1
21	36042.. ..	" stop	1
22	DE366 ..	" " screw	3
23	31161/34564	Gear change stud and banjo	1
24	37733.. ..	" " " banjo, (top)	1
26	34772.. ..	" " " trunnion	2
25	36223.. ..	" " " locknut	1
27	37734.. ..	" " " spring	1
28	34578.. ..	Gear lever	1
29	35411.. ..	" operating sleeve	1
30	34579.. ..	" " arm	1
31	34580.. ..	" lever stud	1
32	27622.. ..	" " " nut	3
33	27916.. ..	" " " washer	1
34	35951.. ..	" thrust pad	2
35	34481.. ..	" locating plunger	1
36	36573.. ..	" " " spring	1
37	34430.. ..	" " " body	1

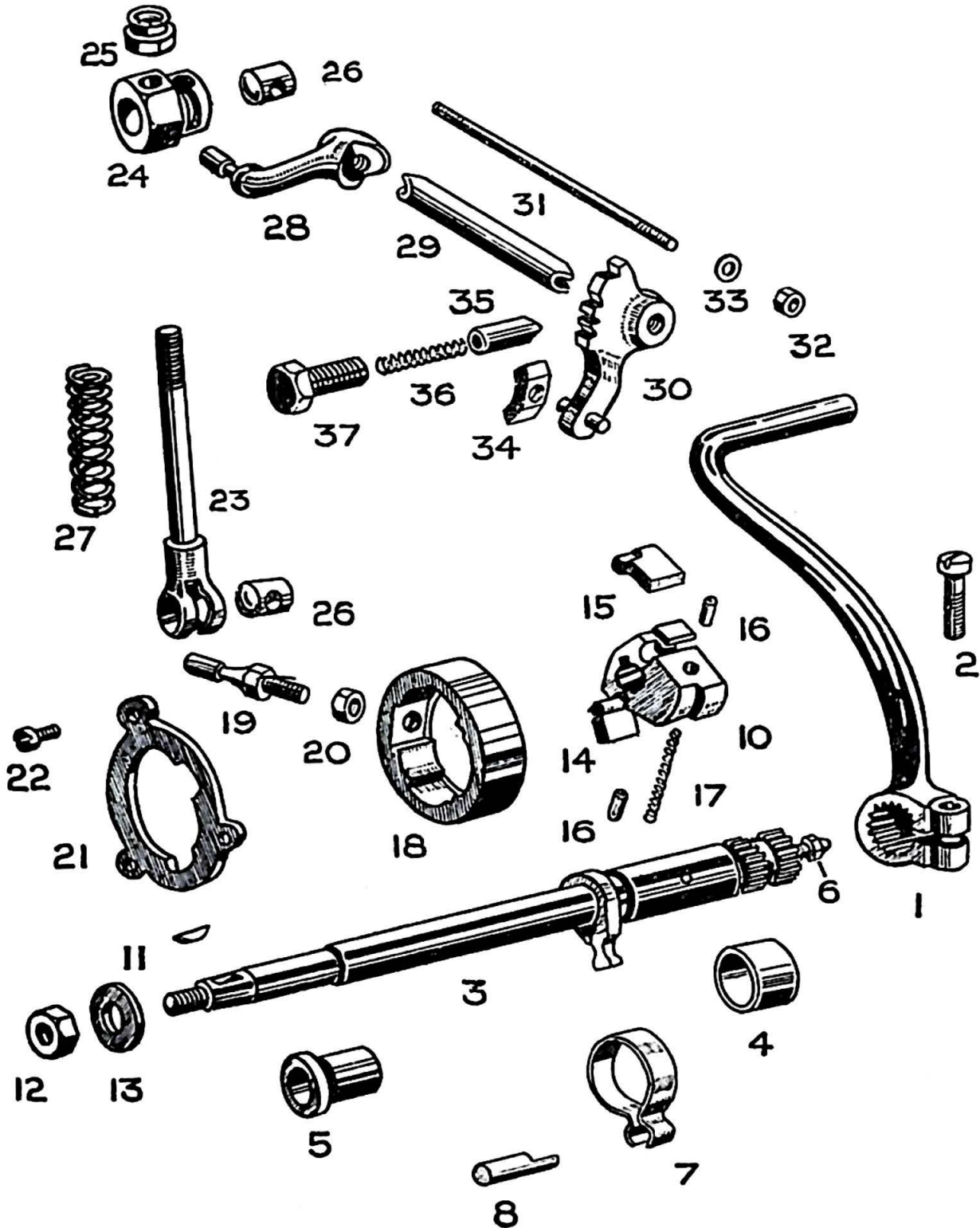

S 459

FRAME AND FOOTRESTS

Illus. No.	No. of part.	Description.	No. per set.
		FRAME	
	44082.. ..	Frame with head races less chainstay	1
1	44081.. ..	Frame, front only	1
2	44077.. ..	" side only, R.H.	1
3	44078.. ..	" " " L.H.	1
4	44095.. ..	" " stud, $\frac{1}{2}" \times 5\frac{1}{4}" \times 16$..	1
	35285.. ..	" " " nut	2
	27920.. ..	" " " s'proof washer ..	2
5	44074.. ..	" " distance tube 6" long	1
6	44094.. ..	" " " " stud $\frac{3}{8}" \times 9\frac{5}{8}" \times 16$	1
	44150.. ..	" " stud nut	2
7	41650.. ..	Head ball race	2
8	33813.. ..	Engine fixing stud $\frac{5}{16}" \times 2" \times 22$ BSF.	1
9	35049.. ..	" " " $\frac{5}{16}" \times 2\frac{3}{8}" \times 22$ BSF.	3
	27944.. ..	Nut, $\frac{5}{16}"$	8
	27917.. ..	Shakeproof washer	8
10	36189.. ..	Rear engine plate	2
11	DE425 ..	Plate stud, top, $\frac{5}{16}" \times 2\frac{9}{16}" \times 22$ BSF	1
12	35049.. ..	" " btm., $\frac{5}{16}" \times 2\frac{3}{8}" \times 22$ BSF	1
	27944.. ..	" " nut	4
	27917.. ..	" " washer	4
15	44516.. ..	Cradle tube, R.H.	1
16	44515.. ..	" " L.H.	1
18	44155.. ..	Chainstay unit	1
19	38375/6 ..	" pivot tube and plugs ..	1
	TC/PZ6 ..	Grease nipple	2
20	38377.. ..	Chainstay pinch bolt	1
21	15601.. ..	" " " stud	1
22	38378.. ..	" " " sleeve	3
23	11509.. ..	" " " nut	3
24	27917.. ..	" " " washer	3
25	38379.. ..	" pivot thrust washer ..	2
26	AR/AT6/7/1129	Suspension unit	2
	30933.. ..	Pivot pin (top)	2
	6740.. ..	" " washer	2
	33783.. ..	" " lock washer (bottom) ..	2
	27918.. ..	" " s'proof washer	2
	DE394 ..	" " nut	4
32	19170.. ..	Footrest rod, $11\frac{1}{2}"$	1
	6740.. ..	" " washer	2
	10315.. ..	" " nut	2
	27918.. ..	" " shakeproof washer ..	2
33	44513.. ..	" arm	2
34	25838.. ..	" rubber	2

State colour when ordering enamelled parts, see page 18.

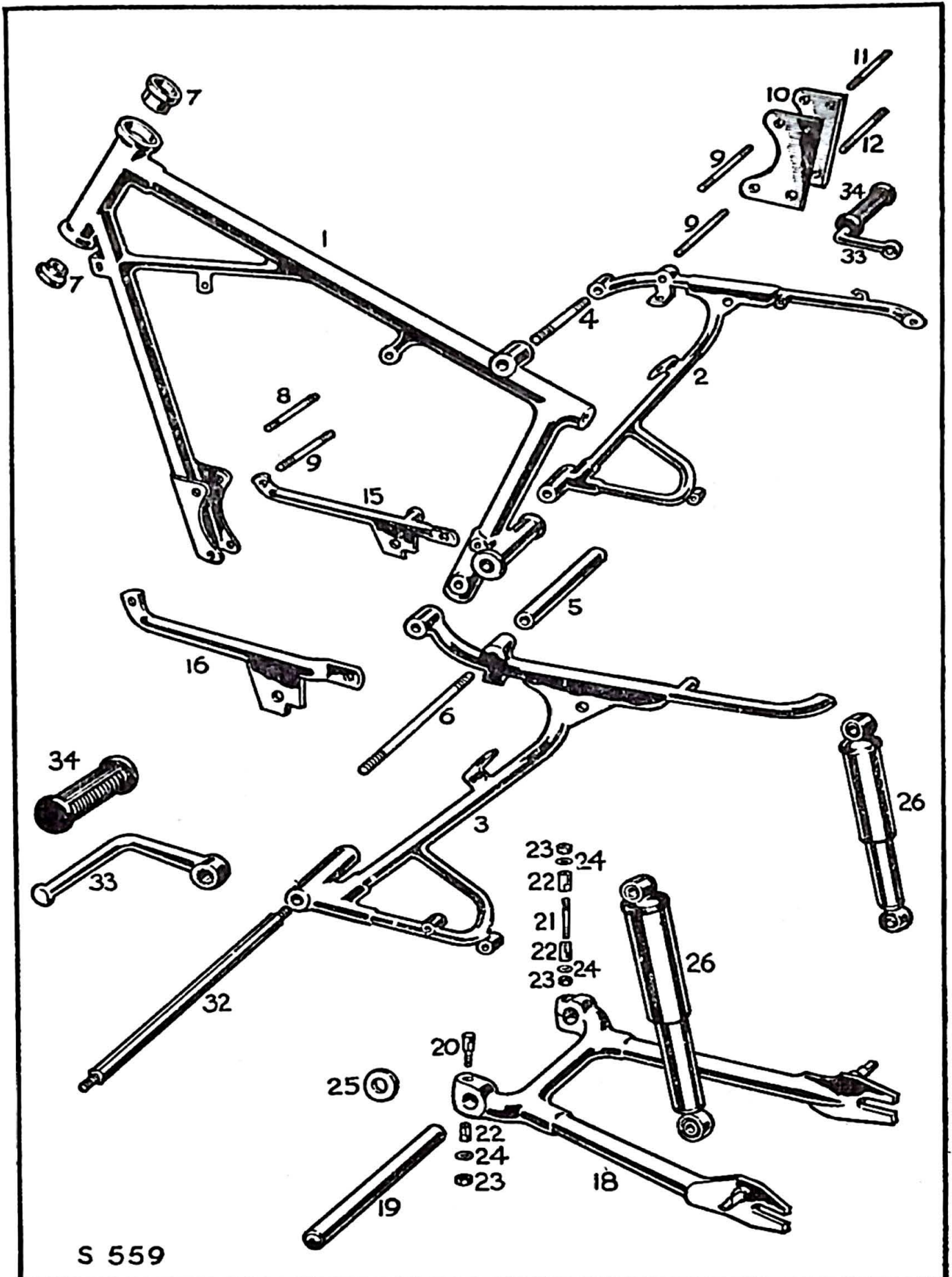

TELESCOPIC FRONT FORK

Illus. No.	No. of part.	Description.	No. per set.
	43485.. ..	Front fork assy. c/w ball head clip and steering stem. Rectified lighting set	1
1	48055.. ..	Steering head bracket	1
2	86166.. ..	" " " adjusting nut ..	1
3	86224.. ..	" " " washer ..	1
4	43441.. ..	Handlebar clip	2
6	26995.. ..	" " nut	4
7	27918.. ..	" " washer	4
8	42868.. ..	Steering stem with lower ball race ..	1
9	26468.. ..	" " ball race	1
10	26402.. ..	" head ball race	1
11	32017.. ..	Ball, $\frac{3}{16}$ " dia.	44
12	86099.. ..	Steering stem clamp	1
13	86225.. ..	" " " stud	1
14	11509.. ..	" " " nut	1
15	12386.. ..	" " " washer	1
16	87008.. ..	Fork crown pinch bolt	2
17	19870.. ..	" " " " nut	2
18	8684.. ..	" " " " washer	2
20	48060A ..	Main tube assy.	2
21	40824.. ..	" " bush (2 halves)	2
22	42864.. ..	" " bolt	2
23	42923.. ..	" " washer	2
24	43484.. ..	" " dust cover	2
25	40821.. ..	Bottom tube assy.	2
30	40825.. ..	" " bush	2
31	40826.. ..	" " gland	2
32	40827.. ..	" " buffer, rubber	2
26	42874A ..	Top spring post	2
27	26998.. ..	" " " nut $\frac{1}{4}$ " \times 26	2
28	27916.. ..	" " " s'proof washer	2
29	42873.. ..	Spring	2
36	40831.. ..	Mudguard stay clip	4
37	18446.. ..	" " " bolt, $\frac{1}{4}$ " \times $\frac{1}{2}$ " \times 26..	4
38	26998.. ..	" " " " nut	4
39	27916.. ..	" " " " s'proof washer	4
	22655.. ..	Licence holder pin	1
	23941.. ..	" " " collar	1
	27917.. ..	" " " s'proof washer	1
	27001.. ..	" " " nut	1

State colour when ordering enamelled parts, see page 18.

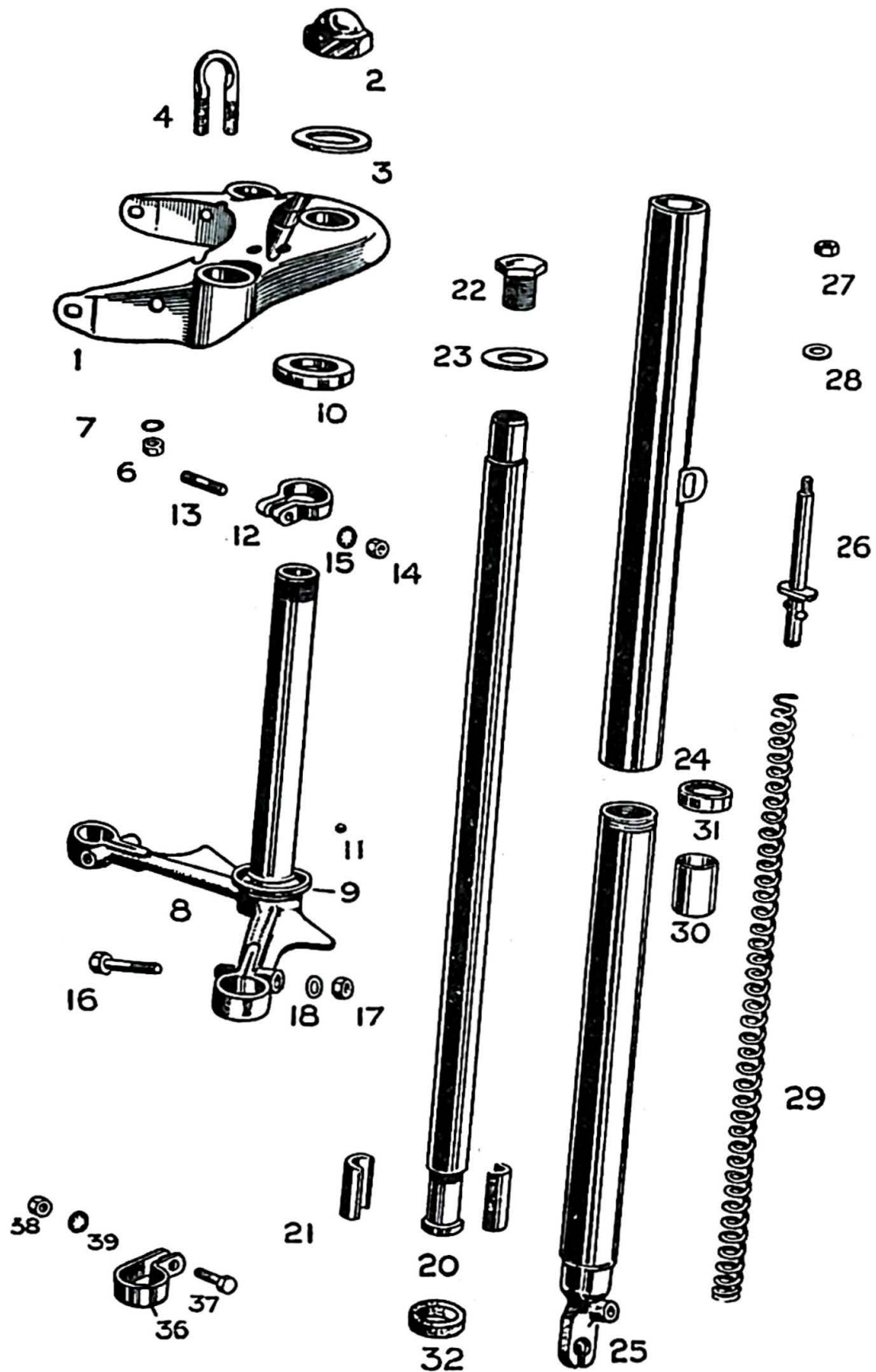

S 6258

FRONT WHEEL, BRAKE & SPEEDOMETER

Illus. No.	No. of part.	Description.	No. per set.
		FRONT WHEEL & BRAKE	
	44826 ..	Wheel, c/w spindle, bearings and brake assy. less tyre	1
1	28949Ch. ..	Rim WMO-19	1
2	36267.. ..	Spoke, brake side, $7\frac{7}{16}" \times 12G.$..	18
3	44987.. ..	„ flange side, $7\frac{1}{4}" \times 12G.$..	18
4	16529.. ..	„ nipple, $12G. \times 56 T.P.I.$..	36
	42785.. ..	Hub c/w spindle, bearings and brake assy.	1
5	42810.. ..	„ only	1
7	39888.. ..	Brake shoe with lining	2
8	39837BX ..	Pair brake linings c/w rivets	1
10	18044.. ..	Shoe return spring	2
12	39881.. ..	Brake plate with fixed fittings ..	1
13	39840.. ..	„ cam and lever	1
14	30674.. ..	Hub spindle	1
15	26374.. ..	„ „ nut.. .. .	2
16	SK/6200 ..	Ball bearing, $10 \times 30 \times 9$ m.m. ..	2
17	26885.. ..	Oil retainer, felt, $\frac{3}{16}"$ thick, brake side	1
19	30536.. ..	Ball bearing retaining nut, flange side	1
20	30535.. ..	Distance collar (behind brake plate)	1
21	36244.. ..	Brake plate locknut (outside brake plate)	1
		SPEEDOMETER & DRIVE	
22	SM/SN3103/20	Speedo. head, 80 m.p.h.	1
	SM/SN3103/22	„ „ 120 k.p.h.	1
	SM/53205 ..	Speedometer light bulb, 6v., 3a., M.C.C.	1
23	SM/53895/25 $\frac{1}{2}$	Flexible drive complete	1
	SM/52108/1/25 $\frac{1}{2}$	„ „ inner cable assy... ..	1
	SM/53898/25 $\frac{1}{2}$	„ „ outer „ „	1
24	SM/52283/1..	Gearbox complete	1
25	32189	Driving ring	1
26	6740.. ..	Packing washer (behind gearbox plate)	1
27	36245.. ..	Distance collar (outside „ „)	1

State colour when ordering enamelled parts: see page 18.

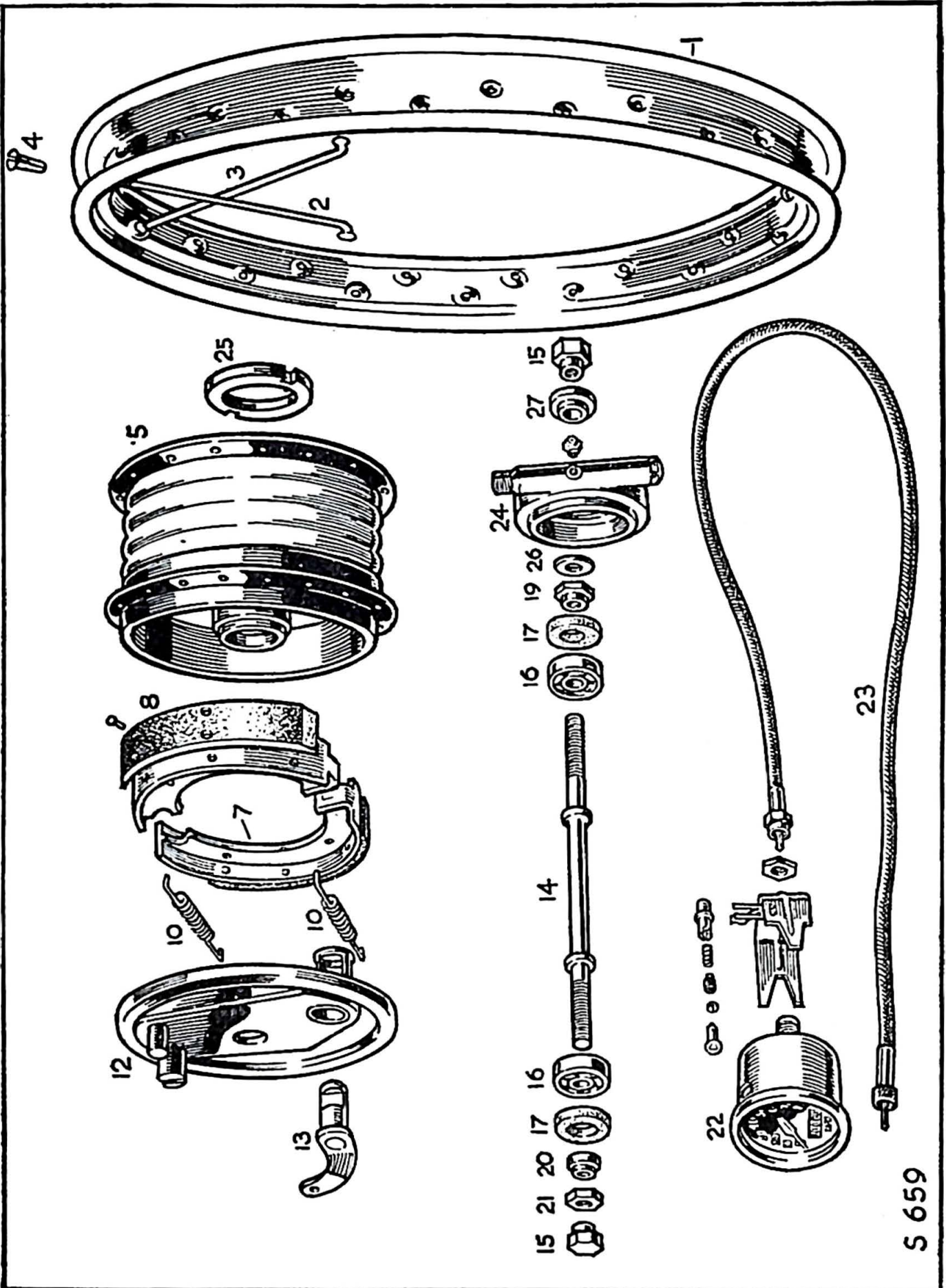

S 659

REAR WHEEL & BRAKE

Illus. No.	No. of part.	Description.	No. per set.
	44827 ..	Wheel, c/w spindle, bearings, brake assy. and 47T sprocket, less tyre ..	1
1	26949Ch. ..	Rim, WMO-19	1
2	26948.. ..	Spoke, 7 $\frac{3}{8}$ " X 12G butted 10G	36
4	16529.. ..	" nipple, 12G X 56 T.P.I.	36
	44929.. ..	Hub with brake assy. and 47T sprocket	1
5	44930.. ..	" only	1
7	42794.. ..	Sprocket, 47T	1
10	44558.. ..	" fixing nut	6
12	39838.. ..	Brake shoe with lining	2
13	39837BX ..	Pair brake linings c/w rivets	1
15	18044.. ..	Shoe return spring	2
17	39862.. ..	Brake plate with fixed fittings	1
18	39866.. ..	" cam and lever	1
19	43458.. ..	Hub spindle	1
20	42962.. ..	" " nut	2
	20018.. ..	" " washer	
21	SK/6201 ..	Ball bearing 12 X 32 X 10 m.m.	2
22	26386.. ..	Oil retainer, felt, $\frac{5}{32}$ " thick, sprocket side	1
23	26385.. ..	" " " $\frac{3}{16}$ " thick, brake side	1
24	26355.. ..	Dust excluder (sprocket side)	1
25	43090.. ..	Ball bearing retaining nut, sprocket side	1
26	42789.. ..	Distance collar (behind brake plate) ..	1
27	43091.. ..	Brake plate locknut (outside plate) ..	1
	27830.. ..	" " packing washer (if reqd.)	1
28	45280.. ..	Driving chain adjuster	2
29	17591.. ..	" " " plate	2
30	44558.. ..	" " " nut	

COLOURS

Most enamelled parts are available in different colours according to the model and year of manufacture, and it is essential to state the colour required if the part is to be supplied correctly.

To indicate the colour, suffix the letters indicating the colour key to the part number, thus:—

44719CR Front Mudguard, cherry red

Parts can only be supplied in the colour (standard or optional) applicable to any particular model.

If no colour is specified the part will normally be supplied in black or the standard colour applicable to the machine.

For the 1959 Prince, Black and Cherry Red is the standard two colour finish.

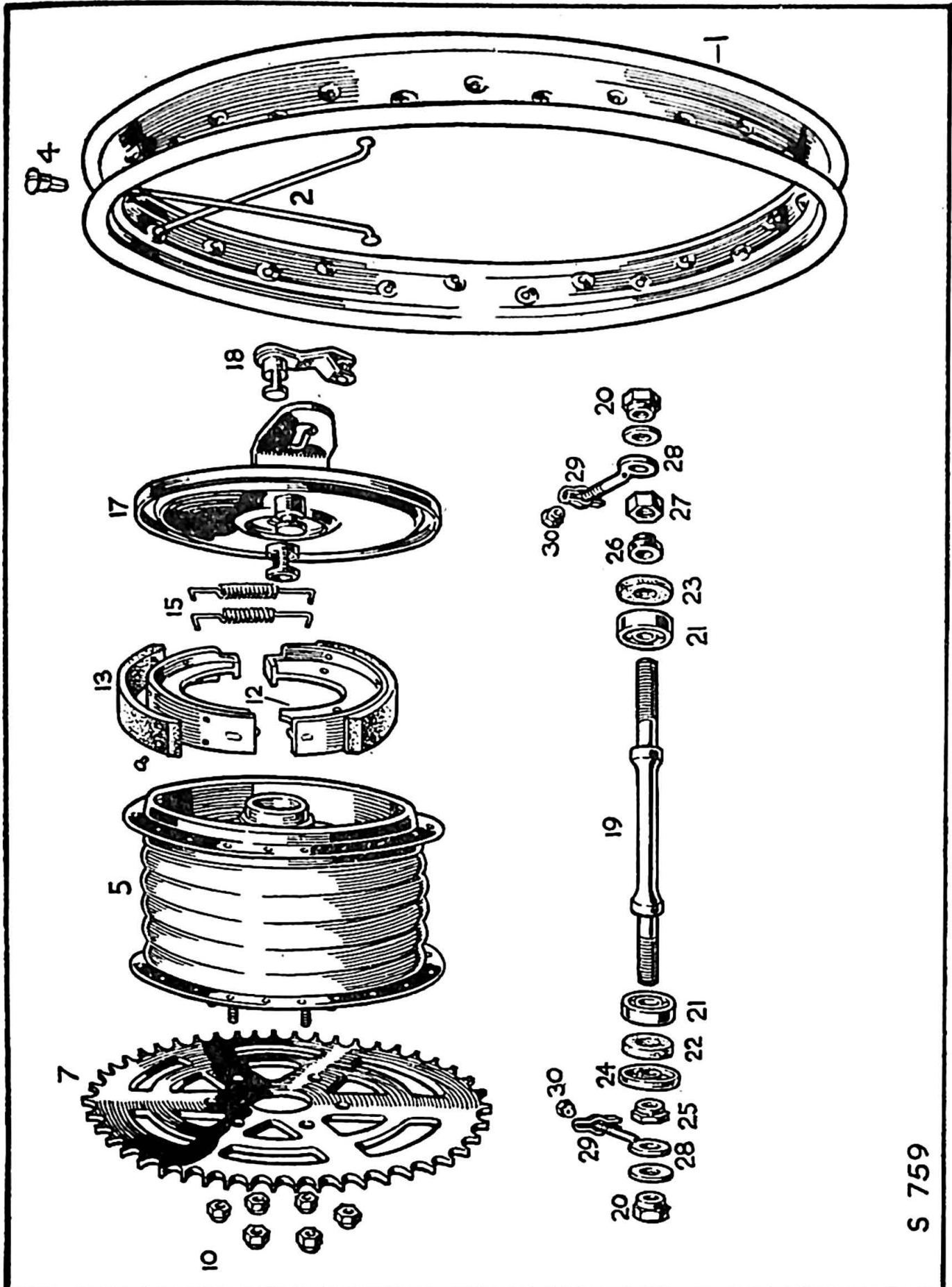

S 759

MUDGUARDS & NUMBER PLATES

Illus. No.	No. of part.	Description.	No. per set.
FRONT MUDGUARD			
1	44719.. ..	Mudguard with stays	1
2	ST74	" front stay	1
3	ST75	" middle stay	1
4	ST76	" rear stay	1
5	36174.. ..	" stay bolt $\frac{5}{16}$ " \times $\frac{1}{2}$ " \times 26.	2
	27917.. ..	" " " s'proof washer	2
6	42623.. ..	Speedo. cable guide tag	1
7	40183.. ..	" " grommet	1
	1083.. ..	" " tag pin	1
	27916.. ..	" " " " s'proof washer	1
	27000.. ..	" " " " nut ..	1
FRONT NUMBER PLATE			
8	38745.. ..	Number plate	1
9	5171.. ..	" " screw	2
10	14904.. ..	" " clip	2
	26999.. ..	" " " nut.. ..	2
	29058.. ..	" " " s'proof washer ..	2
	25226.. ..	" " " packing "	2
REAR MUDGUARD			
12	44496.. ..	Mudguard	1
	36174.. ..	" pin	4
	27917.. ..	" " s'proof washer ..	4
15	251.. ..	Bolt securing guard to seat post	1
	27916.. ..	S'proof washer	3
	39767.. ..	Mudguard carrier end cover (plastic)	2
16	41196.. ..	" " stiffener	2
REAR NUMBER PLATE			
19	44663.. ..	Number plate	1
	41087.. ..	" " beading	1
	22655.. ..	" " fixing screw	2
	27917.. ..	" " " " washer ..	2

State colour when ordering enamelled parts: see page 18.

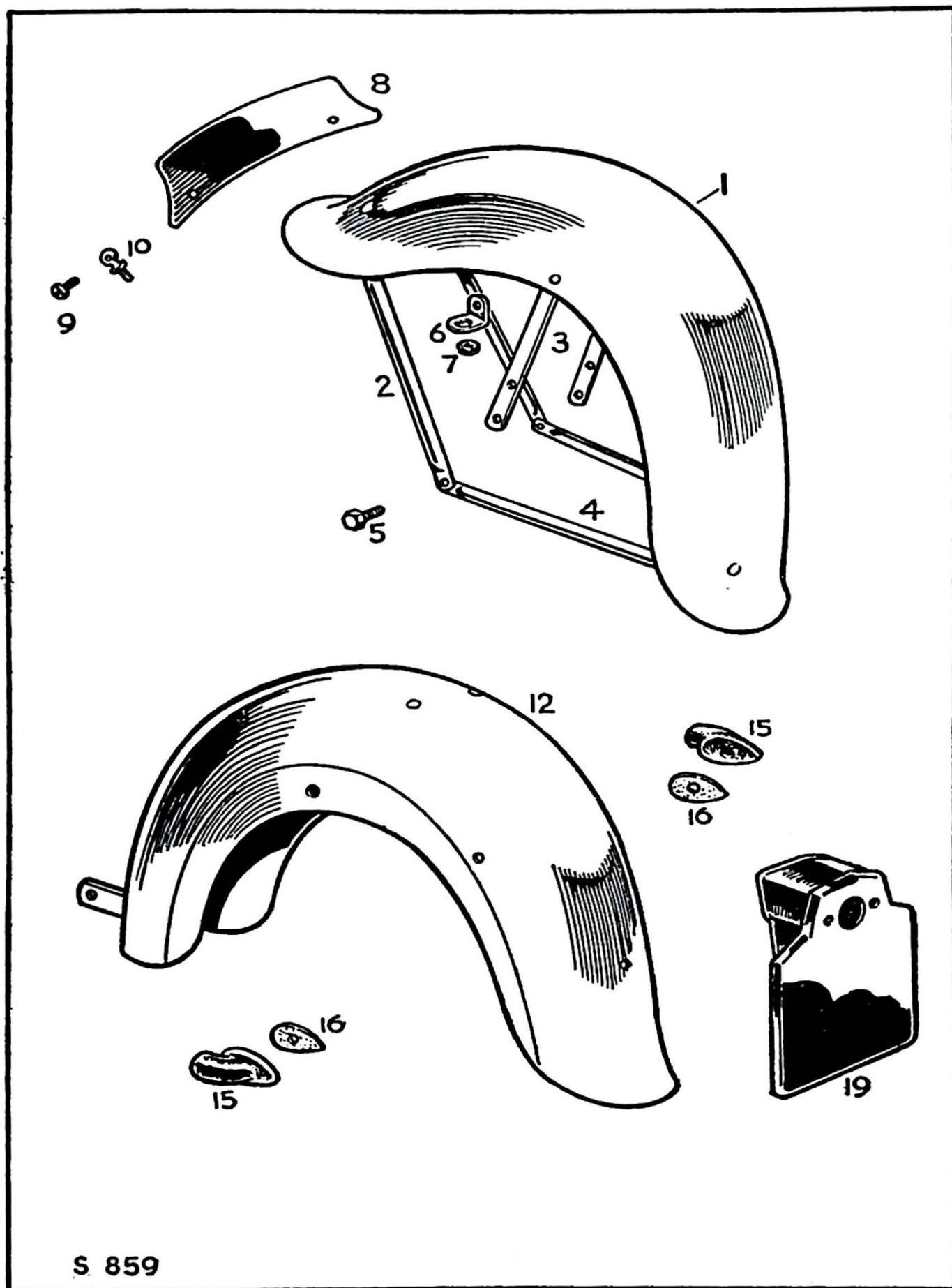

S 859

PETROL TANK, REAR CHAIN & GUARD, BRAKE PEDAL & RODS.

Illus. No.	No. of part.	Description.	No. per set.
PETROL TANK			
	44674.. ..	Petrol tank c/w fittings	1
1	44100.. ..	" " only	1
2	44684.. ..	" " motif, R.H.	1
	44685.. ..	" " " L.H.	1
	44925.. ..	" " " screw	6
3	32488.. ..	Filler cap with oil measure	1
4	39854.. ..	Tank securing stud, front	1
	27916.. ..	" " " s'proof washer	2
	26998.. ..	" " " nut	2
5	26400.. ..	" " " distance tube (front)	1
6	8560.. ..	" " stud, rear	1
	8633.. ..	" " " nut	2
	8634.. ..	" " " washer	2
7	42263.. ..	Petrol pipe	1
8	26965.. ..	" tap	1
	5662.. ..	" " washer	1
REAR CHAINGUARD			
12	44152.. ..	Chainguard top	1
13	44151.. ..	" bottom	1
	27001.. ..	" nut	2
	27917.. ..	" s'proof washer	2
14	44156.. ..	" front	1
	251.. ..	" pin	1
	27916.. ..	" " s'proof washer	1
	RN/110044/111	Rear chain, $\frac{1}{2}$ " \times .205" \times 111 pitches	1
BRAKE PEDAL AND RODS			
16	44521.. ..	Brake pedal	1
18	44527.. ..	" " bearing tube	1
23	44145.. ..	Brake rod link and pivot	1
24	37890.. ..	" " " pivot circlip	1
25	44142.. ..	" " rear	1
26	44143.. ..	" " front	1
27	10480.. ..	" " washer	3
28	28001.. ..	" " split pin, $\frac{3}{16}$ " \times $\frac{7}{16}$ "	3
29	26413.. ..	" " adjusting nut	1
30	44522.. ..	" return spring	1

State colour when ordering enamelled parts: see page 18.

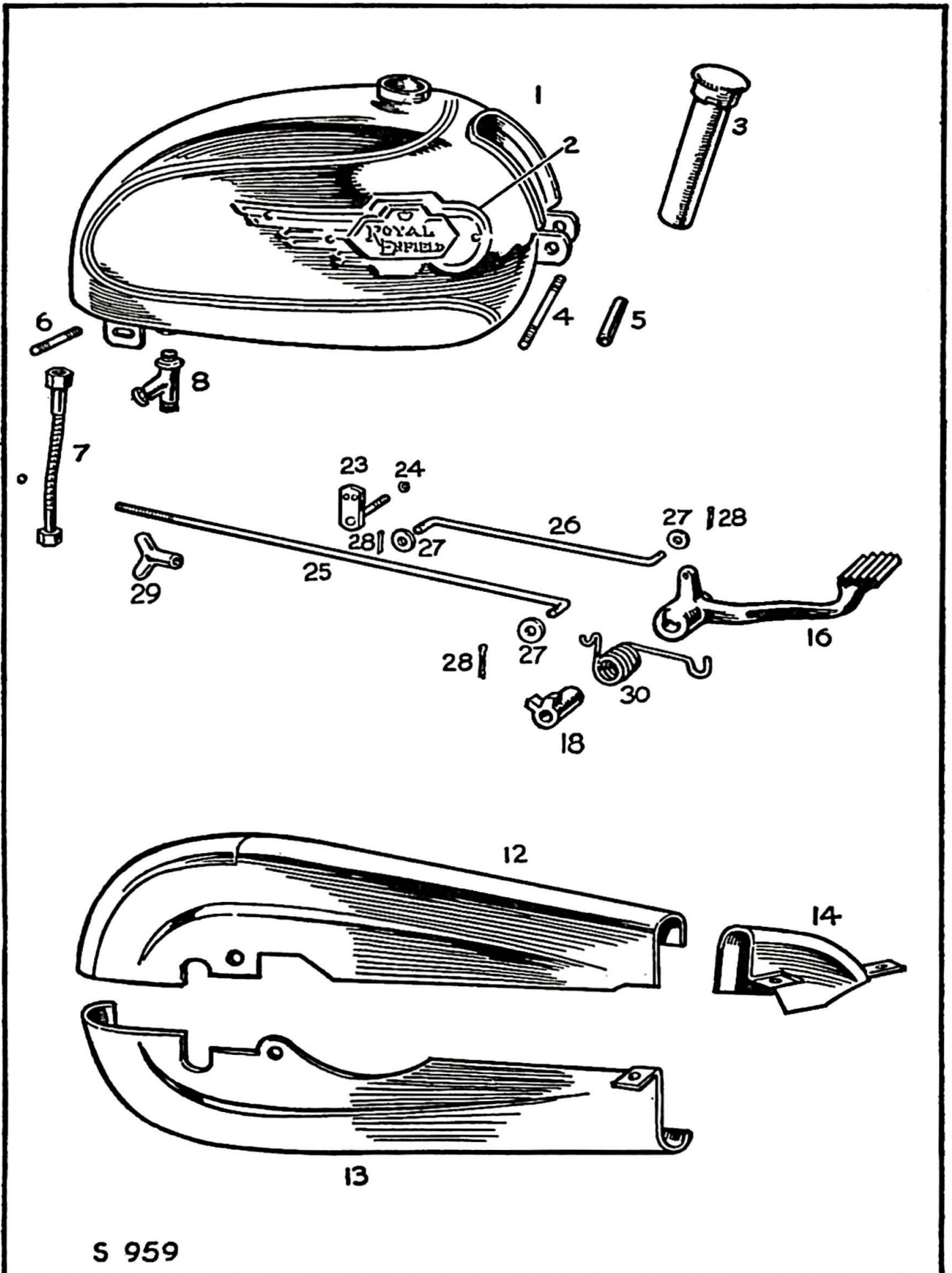

S 959

HANDLEBAR, CONTROLS AND CABLES

Illus. No.	No. of part.	Description.	No. per set.
	44704.. ..	Handlebar c/w controls, less cables ..	1
1	43703/1 ..	Handlebar bend with brackets only ..	1
2	DH/4070LH	Clutch lever c/w pivot pin and nut ..	1
3	DH/4070RH	Brake lever c/w pivot pin and nut ..	1
	DH/78 ..	Twist grip control	1
4	DH/781 ..	" " rotor	1
5	DH/719 ..	" " " rubber	1
6	DH/782 ..	" " clip top	1
7	DH/783 ..	" " " bottom	1
8	DH/786 ..	" " " screw	2
9	DH/784 ..	" " adjuster screw	1
10	DH/785 ..	" " " " nut	1
11	DH/716 ..	" " " spring	1
12	DH/787 ..	" " cable stop	1
13	DH/T4 ..	Dummy grip rubber	1
	44607 ..	Clutch cable complete (long and short cables, c/w connection)	1
15	43279.. ..	Clutch cable assy. long part only ..	1
16	43278.. ..	" " short, with nipples & guide ..	1
17	43275.. ..	Cable guide only	1
18	36492.. ..	" connector	1
19	43276.. ..	" " sleeve	1
	43447.. ..	" " " cover, plastic ..	1
	36492.. ..	" stop	1
22	43898.. ..	" adjuster	1
24	43704.. ..	Front brake cable assy. ..	1
25	21872.. ..	Cable adjuster	1
26	26471.. ..	" " locknut } Brake end ..	1
27	43898.. ..	" adjuster—Handlebar end ..	1
28	10210.. ..	" knuckle	1
29	10211.. ..	" " joint pin	1
	28000.. ..	" " " split pin	1
32	44705.. ..	Throttle cable assy.	1
33	35605.. ..	Cable band, 4" long	4

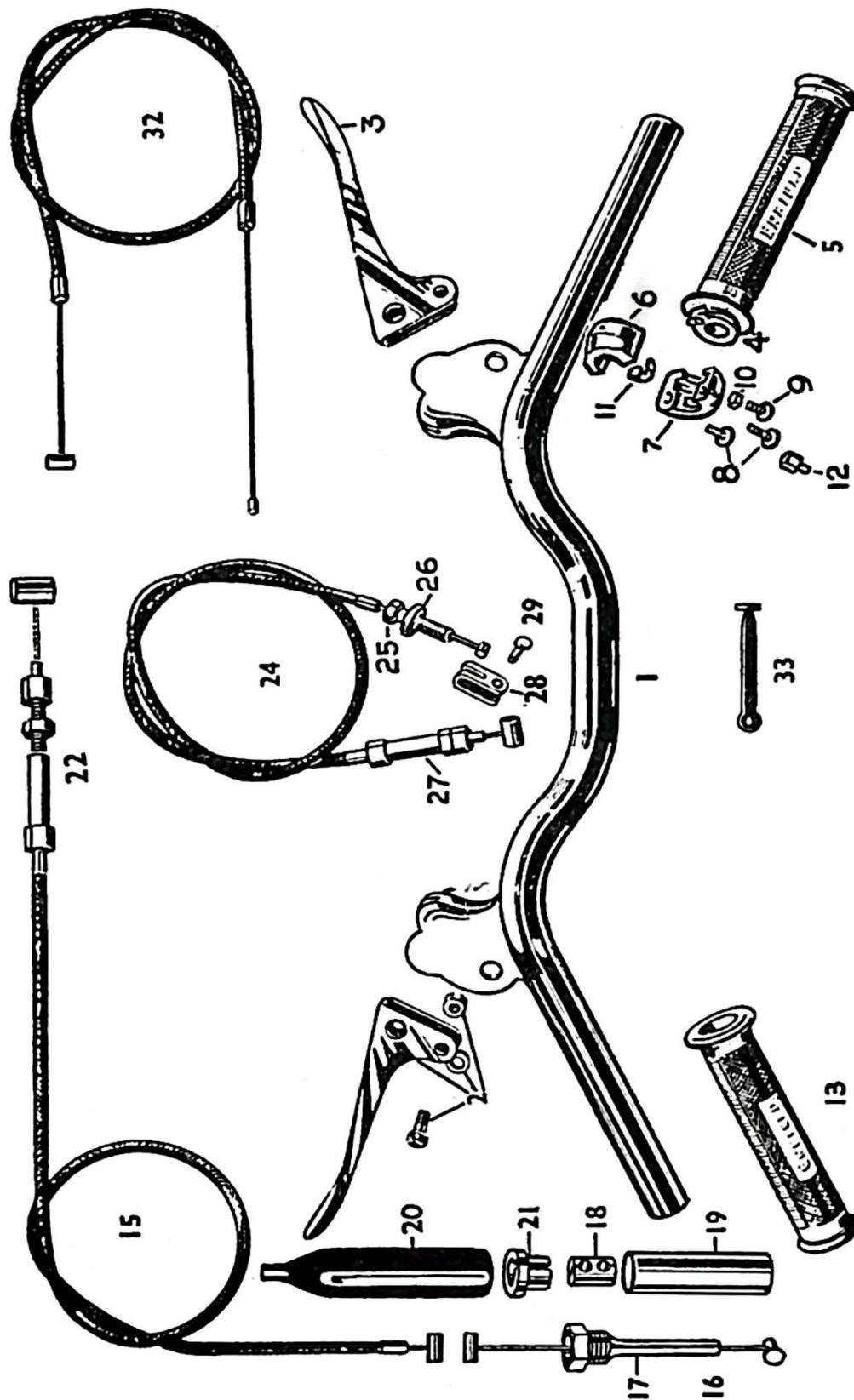

S 1059

EXHAUST SYSTEM, CENTRE STAND AND PILLION FOOTRESTS

Illus. No.	No. of part.	Description.	No. per set.
		EXHAUST SYSTEM	
	44493.. ..	Exhaust system complete	1
1	44494.. ..	Exhaust pipe and silencer assy. only	1
2	44277.. ..	Baffle assy. only	1
3	44489.. ..	Silencer outlet cap	1
4	45352.. ..	" " " seal	1
	43085.. ..	" " " nut	1
	7915.. ..	" " " washer	1
5	42937.. ..	Exhaust pipe clip	1
6	17554.. ..	" " " stud	1
	26998.. ..	" " " " nut	1
	27916.. ..	" " " " washer	1
		CENTRE STAND	
	38986A ..	Centre stand with spring post & greaser	1
10	38893A ..	" " only	1
11	36861.. ..	" " spring post	1
	TC/PZ65 ..	Grease nipple	1
12	38987.. ..	Centre stand bearing sleeve	1
13	38988.. ..	" " spindle	1
	27918.. ..	" " " washer	2
	26995.. ..	" " " nut	2
14	38989.. ..	" " spring	1
		PILLION FOOTRESTS	
18	43455.. ..	Pillion footrest	2
19	41523.. ..	" " pivot block	2
20	41499.. ..	" " " pin	2
	3257.. ..	" " " nut	2
21	41331.. ..	" " " block stud	2
	30807.. ..	" " " " nut, L.H.	1
	10314.. ..	" " " " " R.H.	1
	27919.. ..	" " " " s'proof washer	2
22	25838.. ..	" " rubber	2
	20018.. ..	Silencer washer	1

State colour when ordering enamelled parts: see page 18.

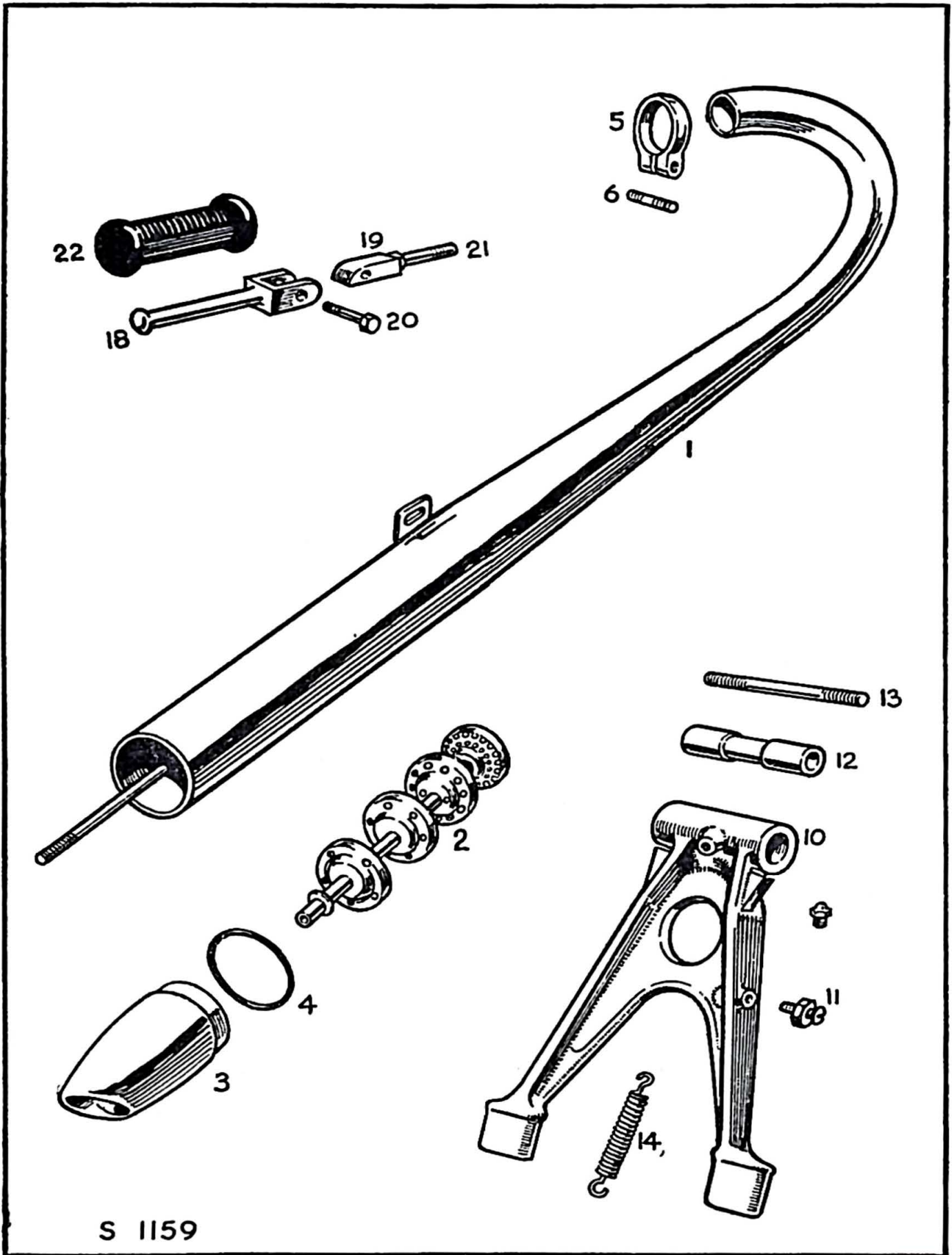

TOOLS & DUAL SEAT

Illus. No.	No. of part.	Description.	No. per set.
		TOOLBOX & TOOLS*	
1	44090.. ..	Battery box with lid, R.H.	1
2	44091.. ..	" strap	1
	251.. ..	" " pin	2
	LU/199001 ..	" cable grommet	1
3	44098.. ..	Tool Box with lid. L.H.	1
4	44092.. ..	Tool and battery box front cover ..	1
	251.. ..	" " " " pin	6
	1083.. ..	Front cover pin	2
	26998.. ..	Box and cover pin nut	8
	27916.. ..	" " " " s'proof washer ..	8
5	DZUS ..	Lid fastener assy.	2
6	44710.. ..	Tubular spanner	1
7	29042.. ..	Tommy bar	1
8	29858.. ..	Spanner $\frac{11}{16}$ " Whit. \times $1\frac{3}{4}$ " C. type ..	1
9	8482.. ..	Screwdriver	1
10	26829.. ..	Tyre lever	2
11	6406.. ..	Combination spanner	1
12	2976.. ..	Spanner $\frac{3}{8}$ " \times $\frac{7}{16}$ " Whit.	1
13	16014.. ..	Grease gun	1
14	29922.. ..	Tyre Inflator	1
15	E5414 ..	Clutch extractor complete	1
16	29921.. ..	Canvas tool roll	1
	27866.. ..	Contact breaker cam extractor bolt, $\frac{5}{16}$ " \times 22 T.P.I.	1
17	ST56 ..	Magneto flywheel extractor	1
18	88206.. ..	Primary driven sprocket extractor ..	1
		DUALSEAT	
20	44669.. ..	Dualseat	1
21	44273.. ..	Dualseat bracket	1
	18446.. ..	" " pin $\frac{1}{4}$ " \times $\frac{9}{16}$ " \times 26 ..	2
	26998.. ..	" " " nut	2
	27916.. ..	" " " s'proof washer ..	2
	16284.. ..	" pin $\frac{5}{16}$ " \times $\frac{11}{16}$ " \times 26	2
	8633.. ..	" " nut	2
	27001.. ..	" " nut	2
	8634.. ..	" " washer	2

*These tools are available but are not necessarily supplied
with new machines.

State colour when ordering enamelled parts : see page 18.

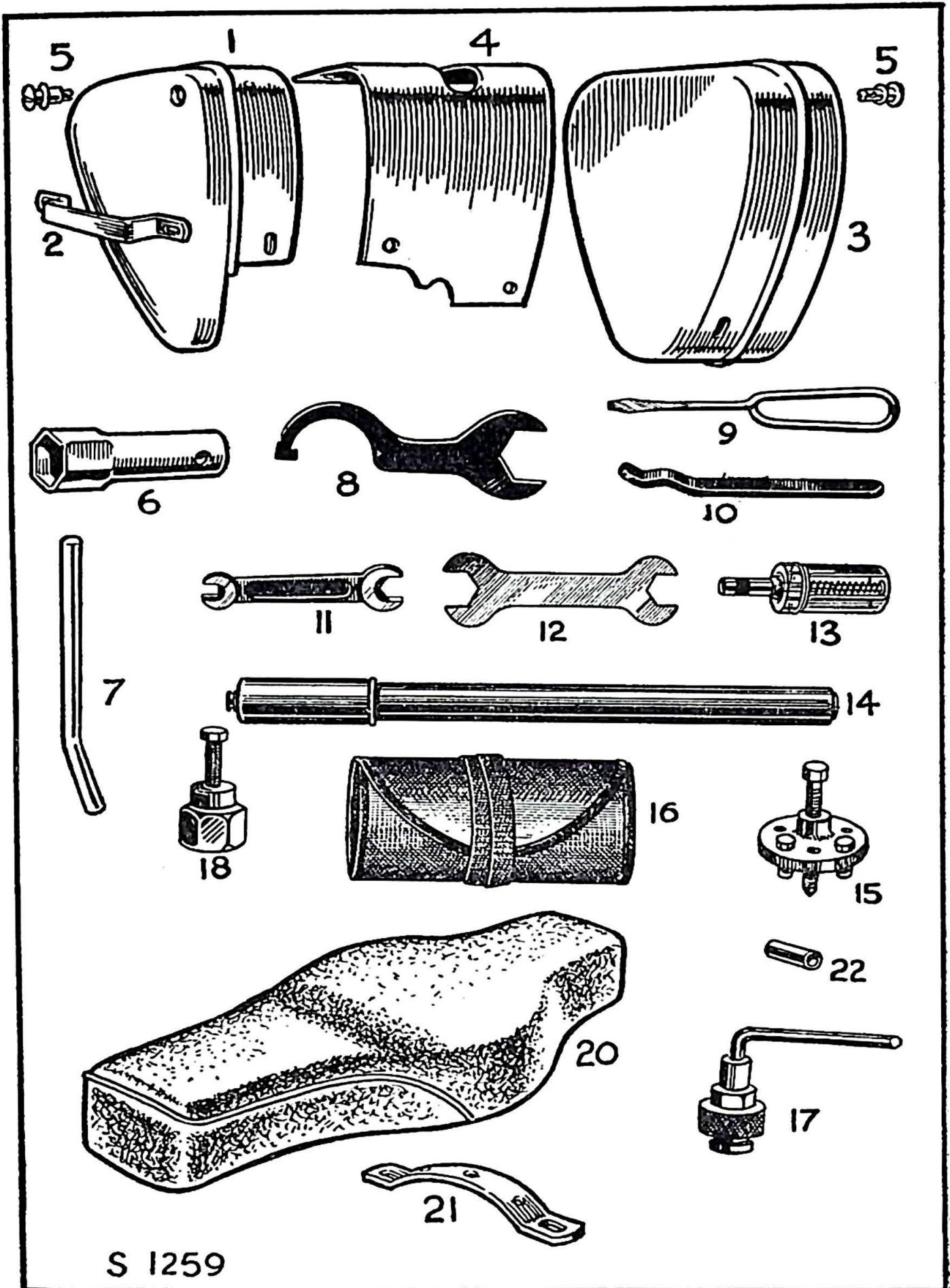

AMAL CARBURETTOR

Illus. No.	No. of part.	Description.	No. per set.
	AM/228/6 ..	Carburettor complete	1
1	AM/228/028	" body	1
2	AM/28/180 ..	" " plug screw ..	1
3	AM/116/147	" " " " washer	1
4	AM/228/011	Mixing chamber top	1
5	AM/4/035 ..	Cable adjuster	1
8	AM/228/019/5	Throttle valve (std. No. 5)	1
9	AM/52/060 ..	" " location screw	1
10	AM/52/057 ..	" " spring	1
11	AM/228/017	" " jet needle	1
12	AM/161/054	" " " " clip	1
13	AM/228/016	Needle jet No. 1075	1
14	AM/4/042/100	Main jet (std. No. 100)	1
15	AM/228/018	" " plug	1
16	AM/228/014	" " " washer	1
17	AM/224/100	Air filter and strangler assy.	1
18	AM/22/108 ..	Float chamber cover	1
19	AM/22/016 ..	" only	1
20	AM/22/014 ..	" needle	1
21	AM/22/110 ..	Tickler assy. complete	1

LEG SHIELDS

Illus. No.	No. of part.	Description.	No. per set.
	ST200.. ..	Legshields, set, with fittings	
1	41886.. ..	Legshield, R.H.	1
2	41885.. ..	" L.H.	1
3	86174.. ..	" pin, $\frac{5}{16}$ " \times $\frac{1}{2}$ " \times 26	4
4	27917.. ..	" " washer	4
5	27001.. ..	" " nut	2
6	41887.. ..	" bracket (top)	1
7	41890.. ..	" " (bottom R.H.)	1
8	41867.. ..	" " (" L.H.)	1
9	22655.. ..	" " pin, $\frac{5}{16}$ " \times $\frac{11}{16}$ " \times 26	2
10	27917.. ..	" " " washer	2
11	27001.. ..	" " " nut	2
12	87123.. ..	Stud (In crankcase, replaces 35049)	1

State colour when ordering enamelled parts: see page 18.

S 1359

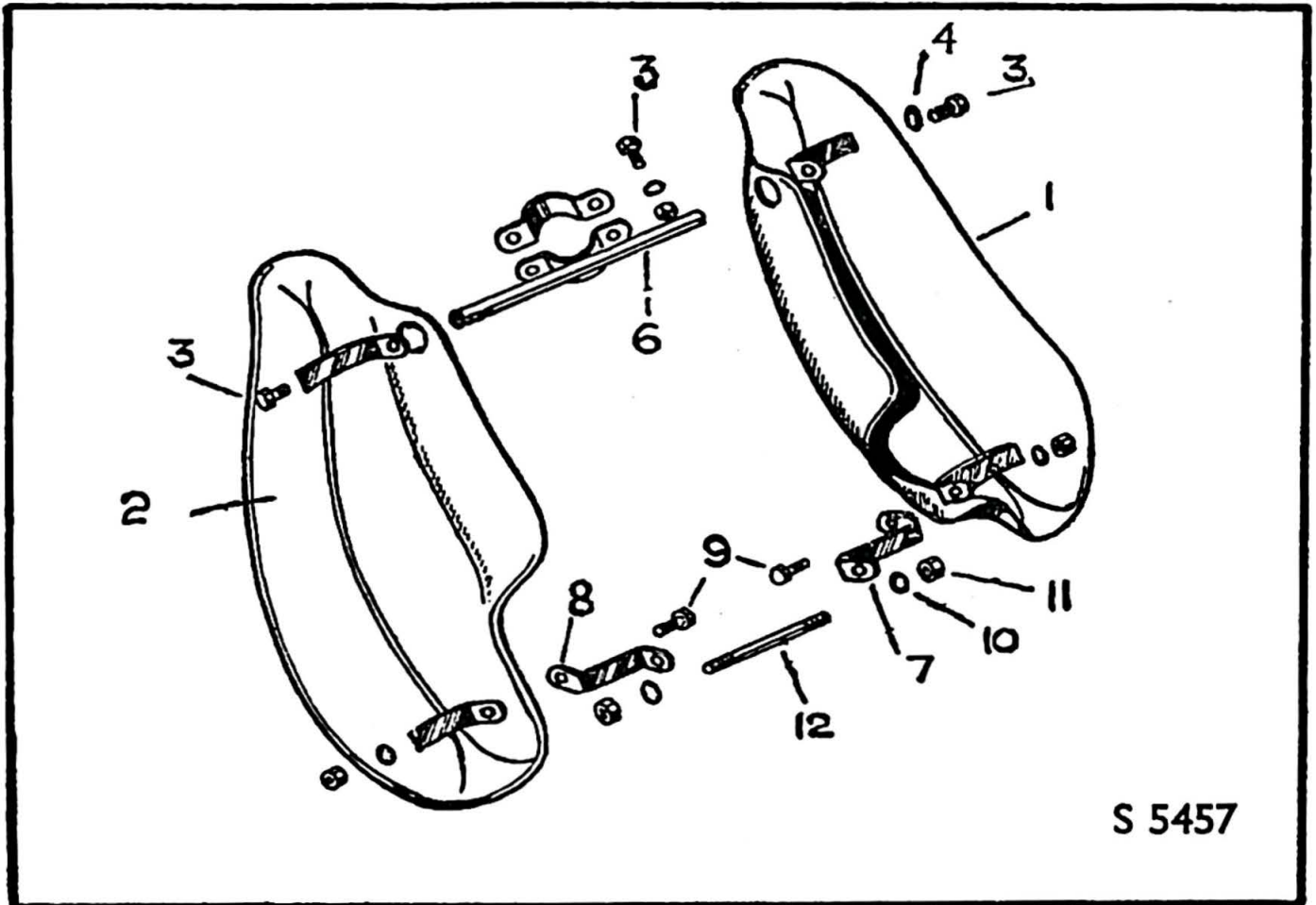
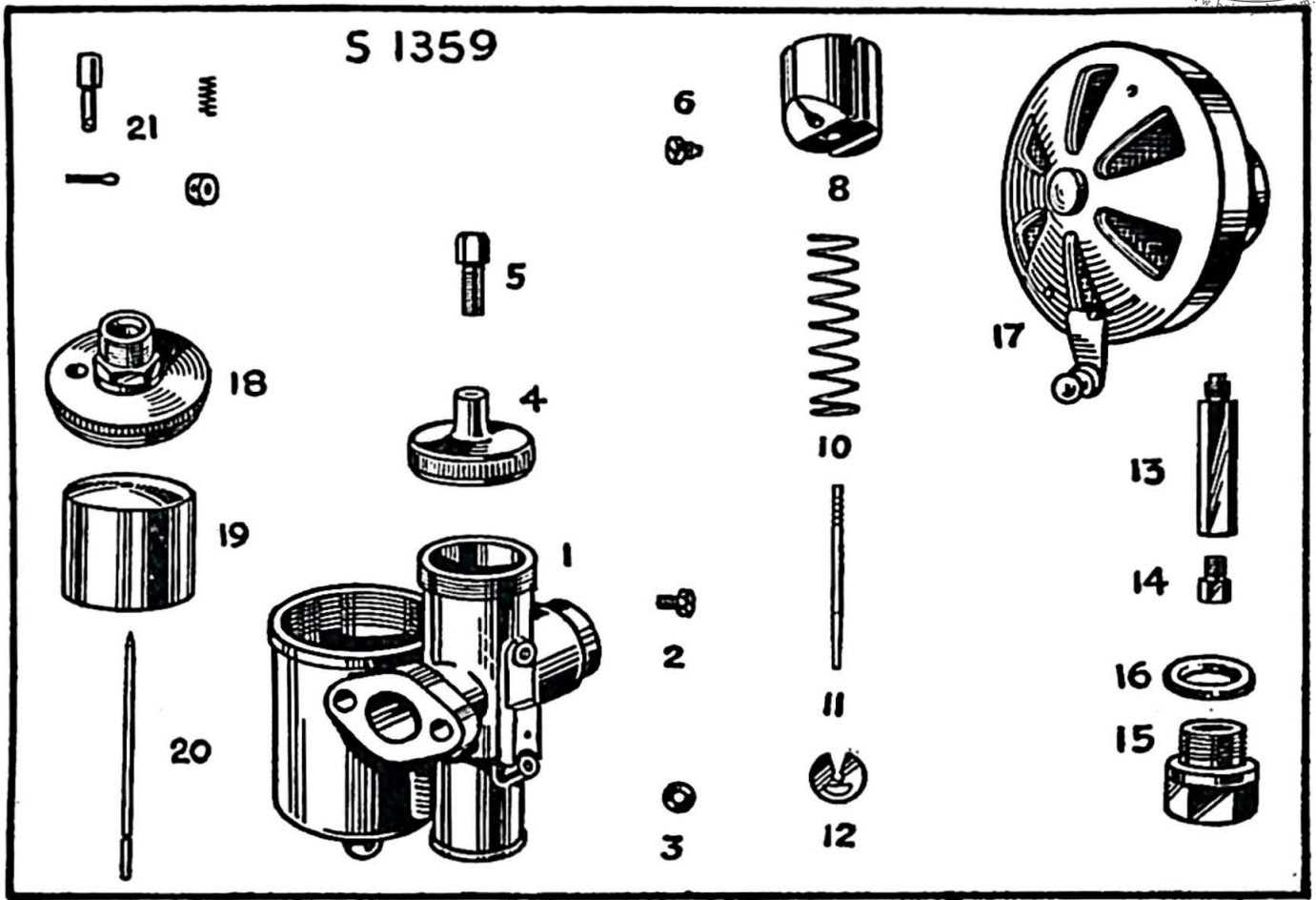

S 5457

ELECTRICAL GENERATOR

Illus. No.	No. of part.	Description.	No. per set.
	45186.. ..	Stator plate c/w coils, condenser, contact breaker, etc.	1
1	ST189 ..	Stator plate only	1
2	85871.. ..	" fixing screw	3
3	DE297 ..	" " " washer	3
4	43192.. ..	Flywheel complete	1
5	11992.. ..	" key	1
6	85870.. ..	" nut	1
7	15380.. ..	" " washer	1
8	86602.. ..	Contact breaker cam	1
9	26808.. ..	" " " screw	1
10	5085.. ..	" " " " washer	1
11	87414.. ..	" " " oiling felt	1
	87402.. ..	Contact breaker c/w fixing screw and washer	1
12	87405.. ..	" " base plate	1
14	ST190 ..	" " fixing screw and washer	1
15	87408.. ..	" " arm	1
16	87404.. ..	" " contact screw	1
17	87406.. ..	" " spring	1
18	85745.. ..	" " cover	1
19	85869.. ..	" " " screw	2
20	*37407/IR ..	Lighting coil (short lead)	1
	*37407/IL ..	" " (long lead)	1
21	87408.. ..	Ignition generating coil	1
22	87409.. ..	Coil fixing screws	6
23	87410.. ..	" support straps	3
24	87411.. ..	Sockets with nuts and insulation	3
25	87412.. ..	Three pin plug complete	1
	86985.. ..	Cable bracket	1
26	87413.. ..	Condenser with fixing screws	1
27	87415.. ..	Ignition coil	1
28	88488.. ..	" " clip	1
29	88490.. ..	" " " bush	1
30	42984.. ..	" " " bolt	1
31	88489.. ..	" " " " nut	1

* These coils are identical except for the length of the lead.

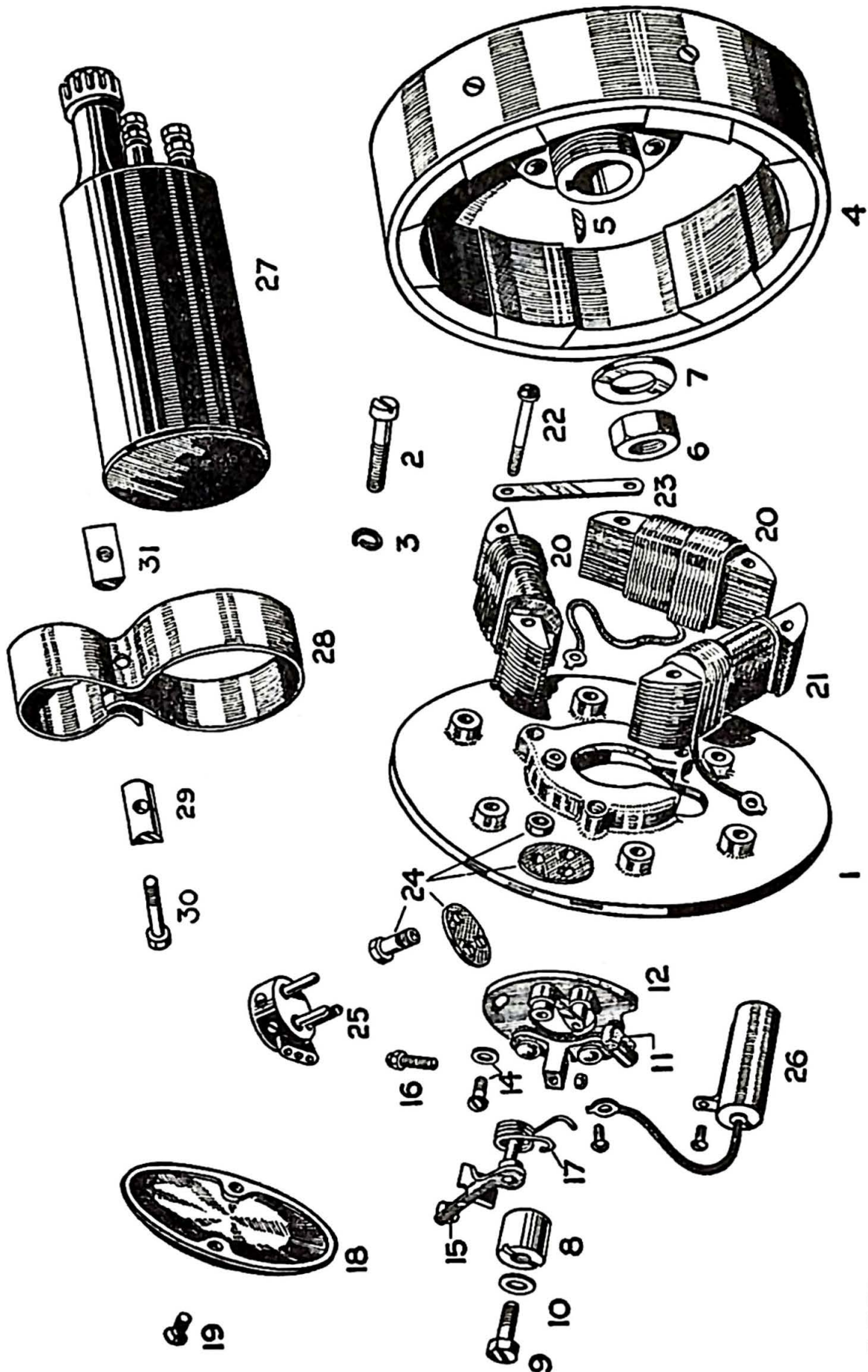

S 353

LAMPS, BATTERY, RECTIFIER, ETC.

Illus. No.	No. of part.	Description.	No. per set.
	MI/69RE ..	Headlamp complete	1
1	MI/69/RE/1..	Lamp body	1
2	MI/600 ..	Reflector and glass unit	1
2A	M1/62/2 ..	Rim	1
3	MI/62/RE/5..	Unit fixing wires	5
4	MI/179/6 ..	Pilot bulb holder	1
4A	M1/S108 ..	Pilot Bulb, 6v., 3w.	1
5	MI/179/8 ..	Bulb holder complete	1
5A	LU/312 ..	Main Bulb, 6v., 30 X 24w.	1
6	MI/69/RE/9..	Main switch complete	1
7	MI/69/RE/10	Switch cover	1
8	MI/R228/A ..	Switch lever and screw	1
	MI/69/110 ..	Lamp securing bolts and washers	2
9	MI/75V/882..	Ammeter	1
	MI/S138 ..	Ammeter rubber ring	1
	MI/S147 ..	Switch fibre washer	1
	MI/S148 ..	Switch fixing nuts and washers	2
	MI/S149 ..	Switch contact screws	8
10	MI/S157 ..	Dip/Horn switch less cables	1
	MI/S157A ..	Dip/Horn switch cables	1
11	LU/MK9E ..	Battery	1
12	MI/LAS146..	Rectifier	1
	29419.. ..	" pin	1
	27916.. ..	" " s'proof washer	1
	26998.. ..	" " nut	1
13	LU/70142B	Electric horn, HF1849	1
14	43489.. ..	" " bracket	1
	82428.. ..	" " screw	2
	26999.. ..	" " " nut	2
	29058.. ..	" " " washer	2
	MI/88ET ..	Tail lamp complete	1
20	MI/88/14 ..	Back plate c/w nuts and washers	1
21	MI/88/2 ..	Nuts & washers (set, 2 each)	1
22	MI/88/8A ..	Transparent moulding	1
23	MI/88/4 ..	Moulding gasket	1
24	MI/88/5 ..	" screw	2
25	MI/88/6 ..	" " rubber washer	2
26	MI/88/6 ..	Bulb 6v. 3w...	1
27	MI/88/7 ..	" spring	1
28	MI/88/13 ..	Cable & pad	1
29	MI/88/9 ..	" shield	1
30	MI/88/11 ..	Rubber connector	1

State colour when ordering enamelled parts: see page 18.

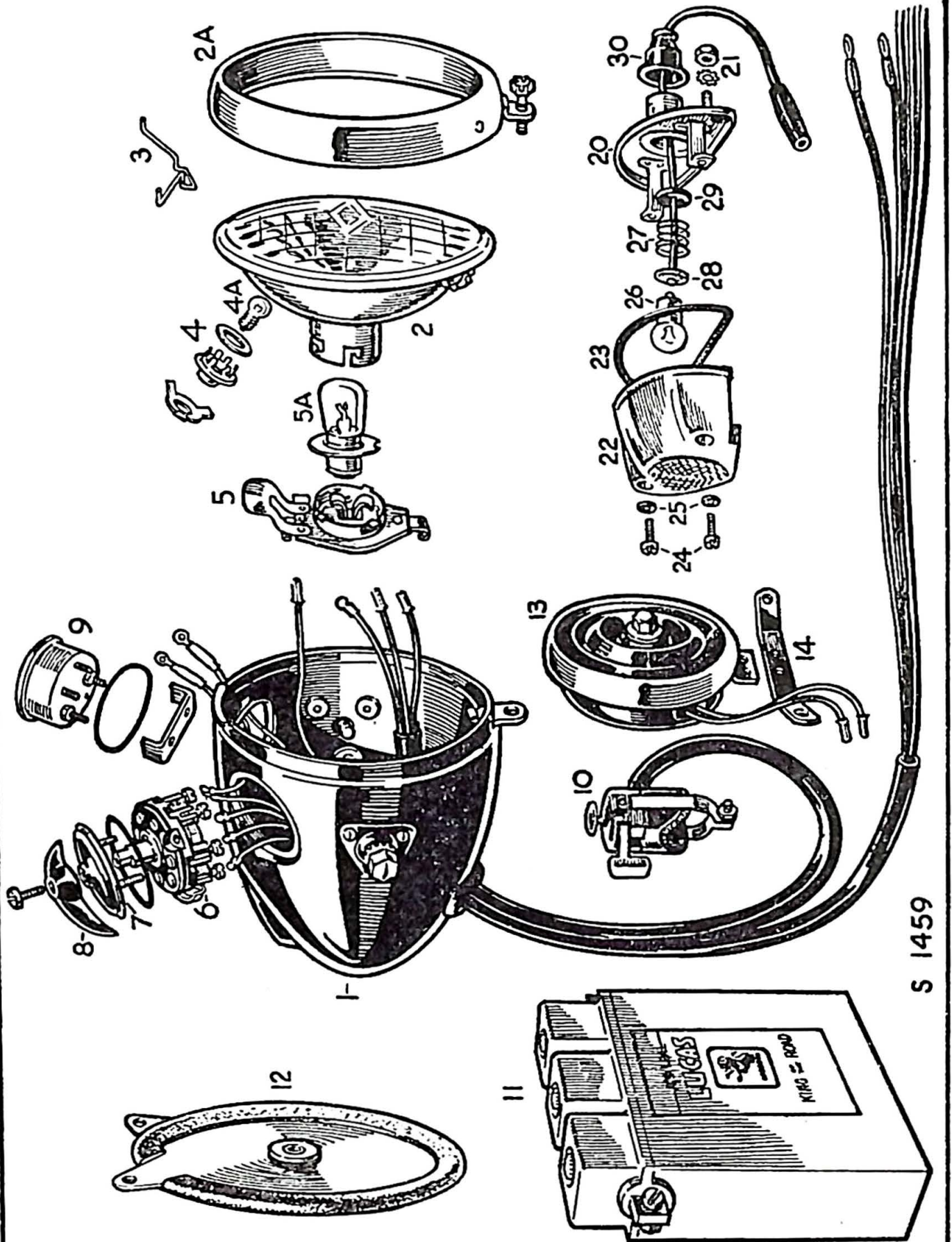

S 1459